

① H09A - Ground Floor - End & Mid Terrace
1 : 100

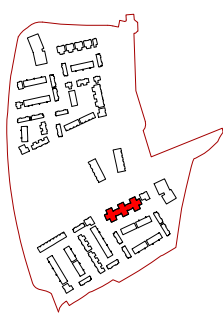
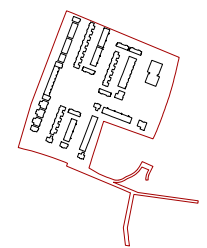

House Type 9A Floor Plans

| Revision Description | Date | Rev. No. | Issued by |
|----------------------|------------|----------|-----------|
| For Planning - Draft | 14/09/2020 | 1 | AW |
| For Planning | 25/09/2020 | 2 | SK |
| | | | |
| | | | |
| | | | |
| | | | |
| | | | |

omahony pike

architecture | urban design | Dublin | Cork
 email: info@omahonypike.com | The Chapel | One South Mall
 tel: +353 1 202 7400 | Mount St. Anne's | Cork City
 fax: +353 1 283 0822 | Milltown, Dublin 6 | Co. Cork
 www.omahonypike.com | D06 XNS2 Ireland | T12 CCN3 Ireland

Project: Dunshaughlin Phase 2
Location: Dunshaughlin, Co.Meath
Client: Castletorn Construction ULC

Project No.: 1217A
Project Lead: CK
Drawn By: SK
Job No.: 1217A
Purpose: For Planning

Scale @ A3: As indicated
Date Printed: 25/09/2020
Current Rev.: 2
Status: S4

Drawing Title: House Type 9A Floor Plans
Drawing No.: 1217A-OMP-H9-00-DR-A-1000

Source File:

H09A - Area Schedule

| Level | Area |
|-------|---------------------|
| GF | 70.8 m ² |
| | 70.8 m ² |

Figured dimensions only to be used. This drawing is copyright of O'Mahony Pike Architects Ltd. All information is shared as per approved use in accordance with ISO19650-2:2018, Table 5; Standard Codes for Suitability of Models and Documents and the BEP. If the 'Status' field is empty, this information has been shared at 50 - WIP.